

A901C-W 电磁执行器（配 PZ 泵）安装说明

步骤 1、拆开
小盖板

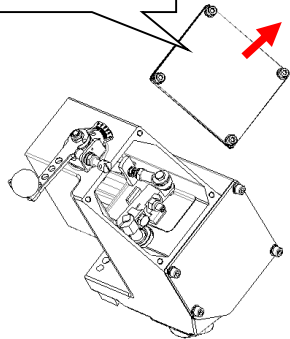

图一

步骤 2、拧松
六角螺栓

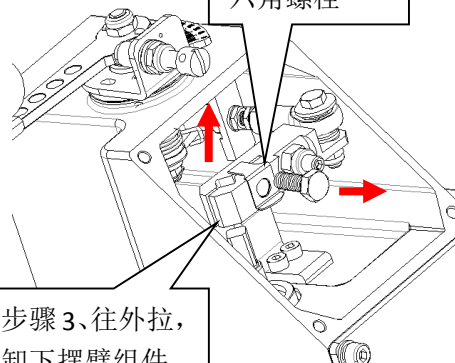

步骤 3、往外拉，
卸下摆臂组件

图二

步骤 4、拿出卸
下的摆臂组件

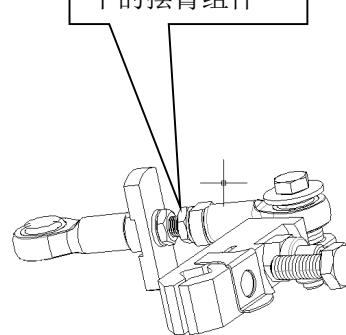

图三

步骤 5、把摆臂组件与
油泵齿条连接固定好
（齿条用第二个孔）

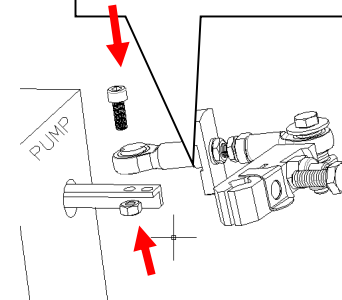

图四

注意齿条
拉到底！

步骤 6、把摆臂
组件穿进电磁
执行器内

步骤 7、拉紧摆臂
组件，保证油泵
齿条往外拉到底



图 6

步骤 8、将执行器对正
孔位，安装到油泵中间
体上，紧固相关连接螺
栓。



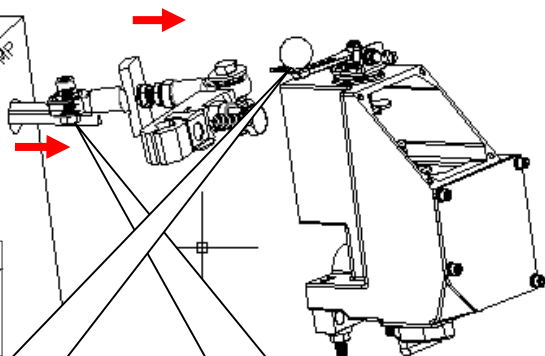
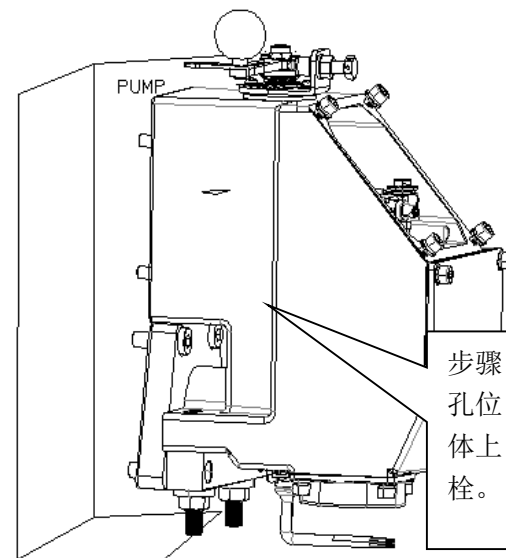
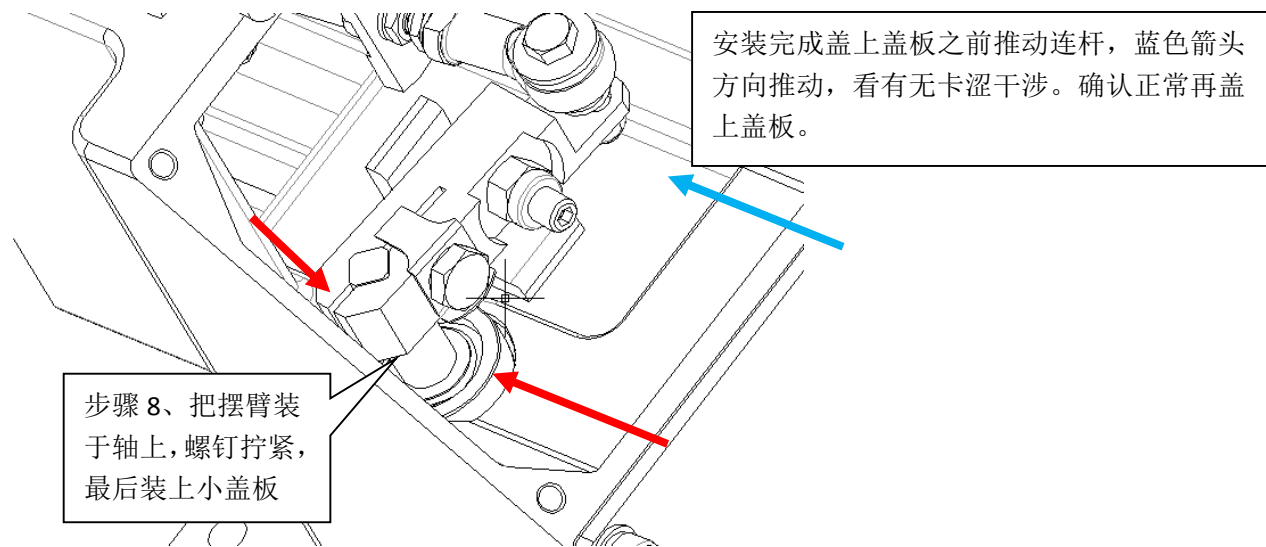

图七

A901C-W electromagnetic actuator (with PZ pump) installation instructions

Step 1, open the small cover

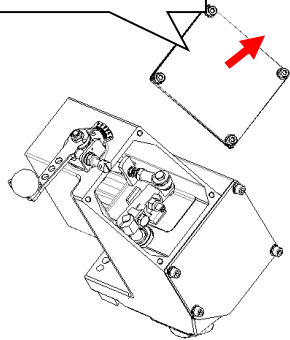

Figure 1

Step 2, loosen the Hexagon bolt

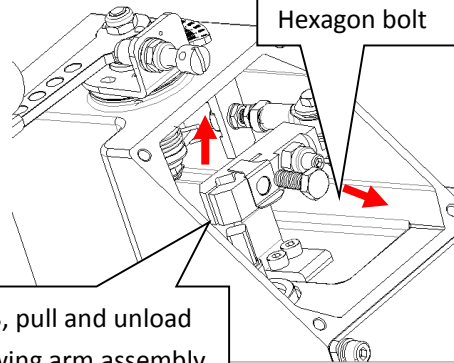

Figure 2

Step 3, pull and unload the Swing arm assembly

Step 4, remove the swing arm assembly

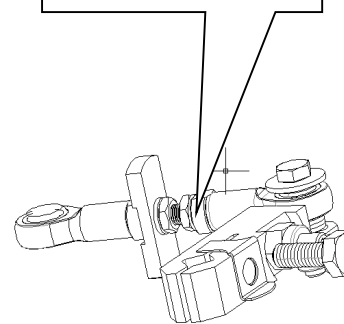

Figure 3

Step 5, the swing arm assembly is connected with the oil pump rack (using the second holes)

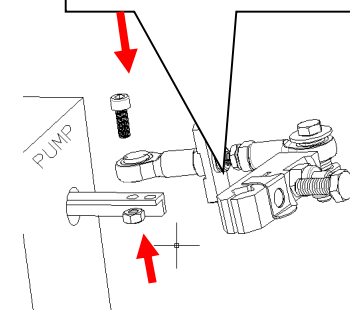

Figure 4

Step 8. Install the actuator to the positive hole position and install to the intermediate body of the oil pump, fastening the relevant connecting bolts.

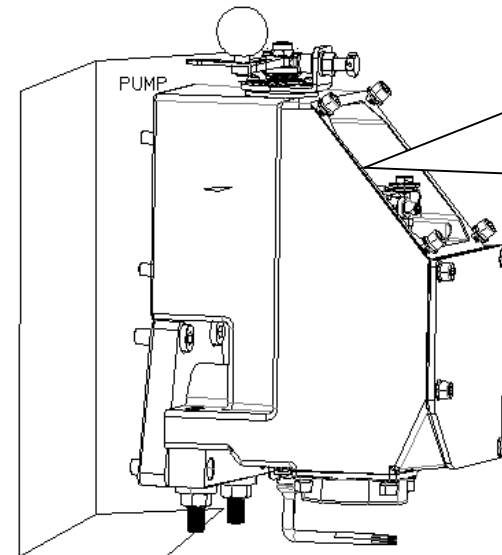
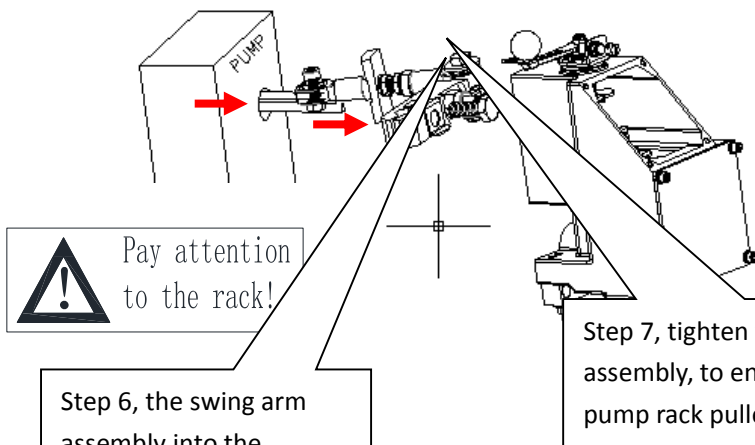

Figure 6

Step 7, tighten the swing arm assembly, to ensure that the oil pump rack pulled out in the end

Pay attention to the rack!

Step 6, the swing arm assembly into the electromagnetic actuator



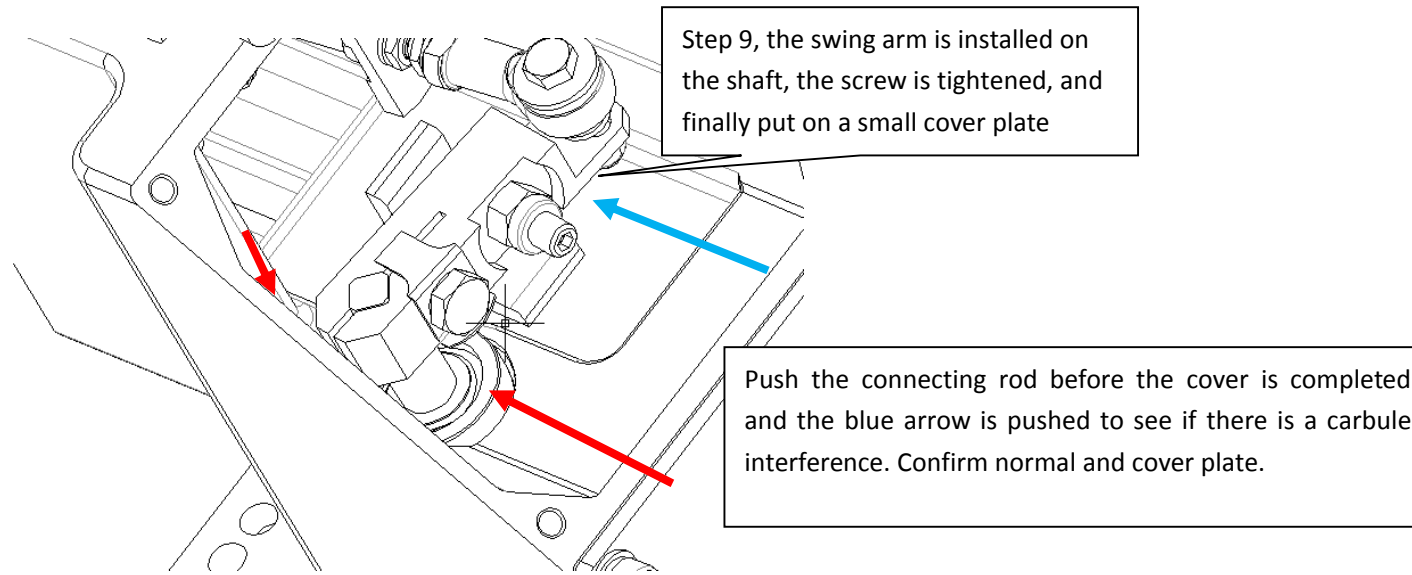

Figure 7