

# A901C-W 电磁执行器（配 P10 泵）安装说明

步骤 1、拆开小盖板

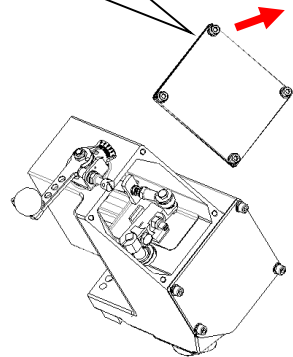

图一

步骤 2、拧松六角螺栓

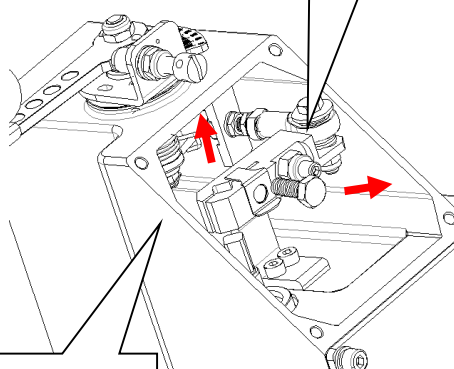

图二

步骤 4、拿出卸下的摆臂组件

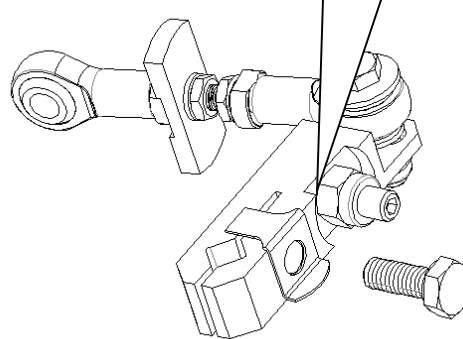

图三

步骤 5、把摆臂组件与油泵齿条连接固定好

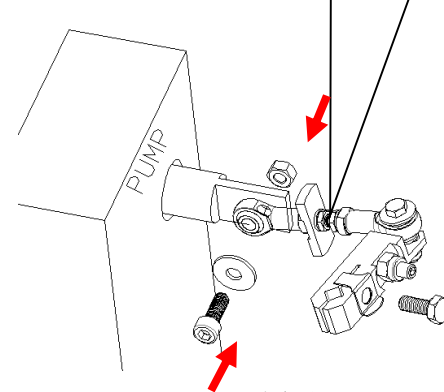

图四

步骤 3、往外拉，卸下摆臂组件

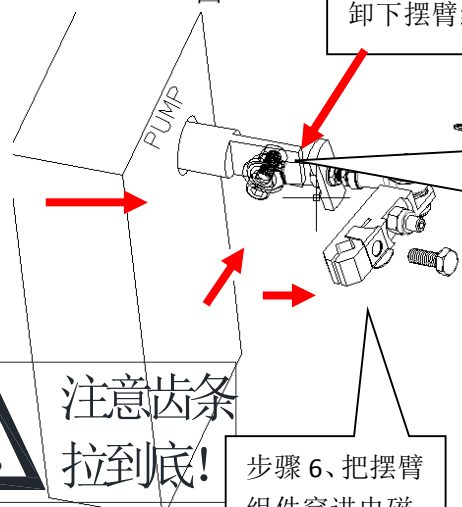

步骤 7、锁紧螺栓螺母，拉紧摆臂组件，保证油泵齿条往外拉到底

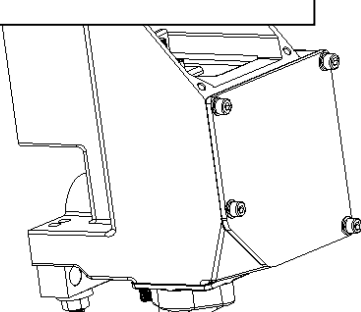

图五

步骤 6、把摆臂组件穿进电磁执行器内

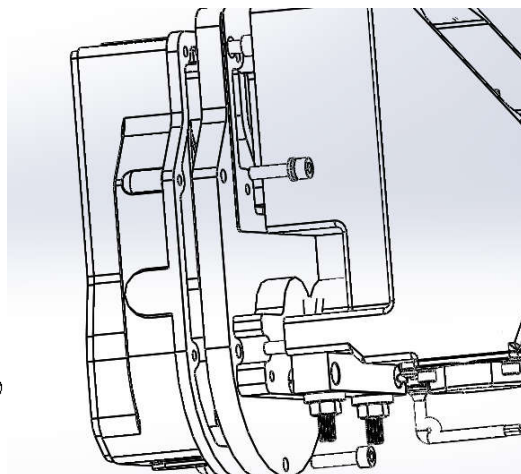

图六

步骤 8、将执行器对正孔位，安装到油泵中间体上，紧固相关连接螺栓。

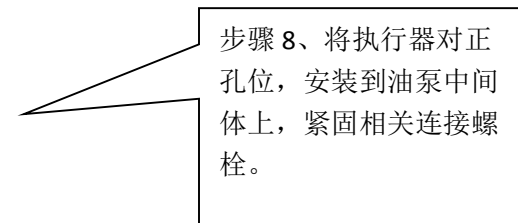

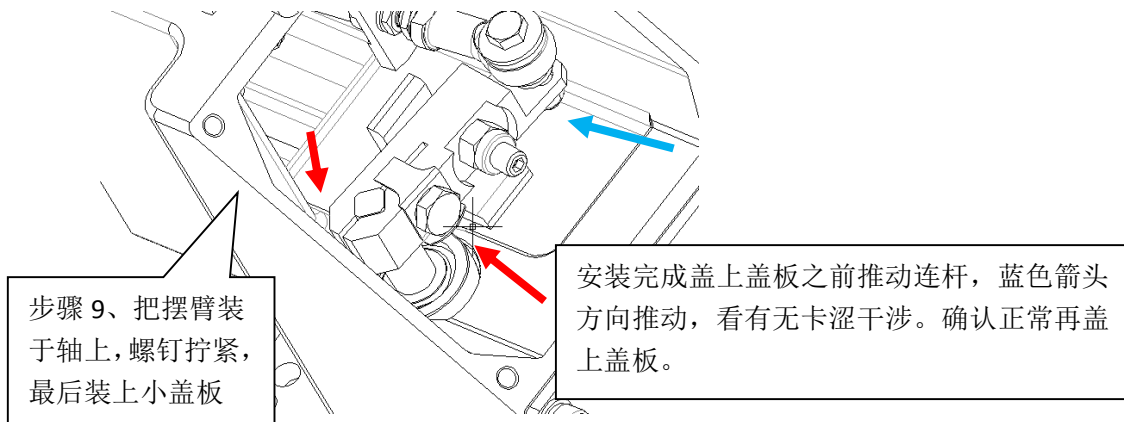

图七

# A901C-W electromagnetic actuator (with P10 pump) installation instructions

Step 1, open the small cover

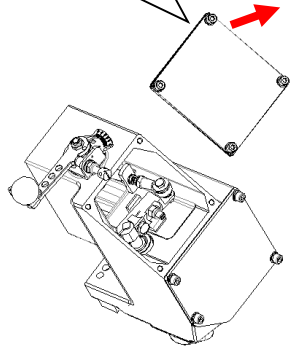

Figure 1

Step 2, loosen the Hexagon bolt

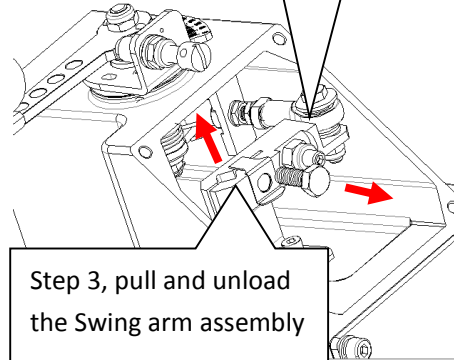

Figure 2

Step 3, pull and unload the Swing arm assembly

Step 4, remove the swing arm assembly

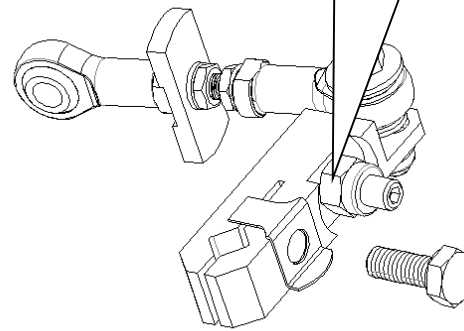

Figure 3

Step 5, the swing arm assembly is connected with the oil pump rack

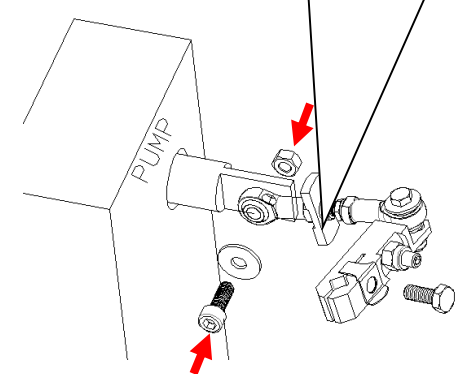
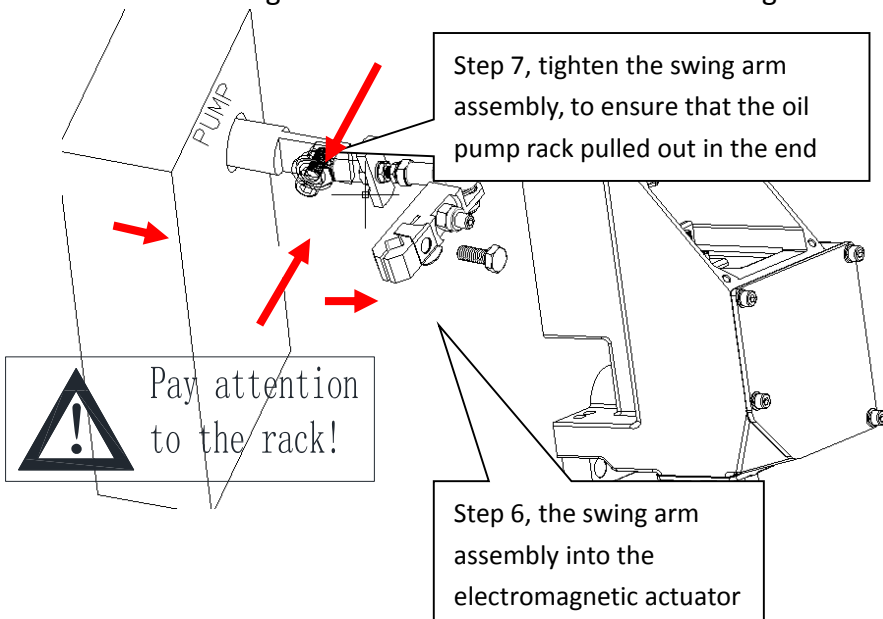

Figure 4

Step 7, tighten the swing arm assembly, to ensure that the oil pump rack pulled out in the end



Step 6, the swing arm assembly into the electromagnetic actuator

Step 8. Install the actuator to the positive hole position and install to the intermediate body of the oil pump, fastening the relevant connecting bolts.

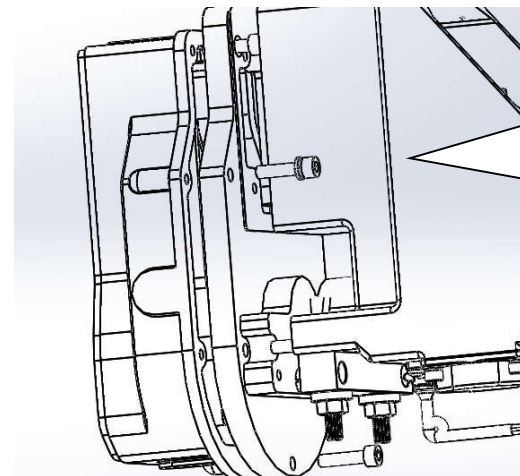

Figure 6

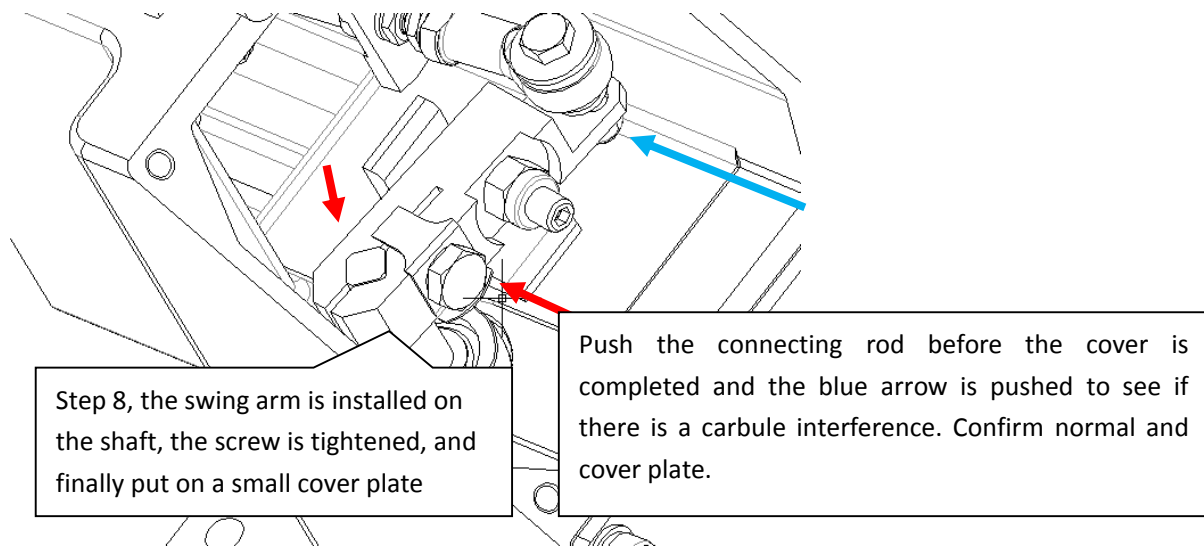

Figure 7