

850nm VCSEL - 25mA

2835 package

Part number

RS-2835-09-850

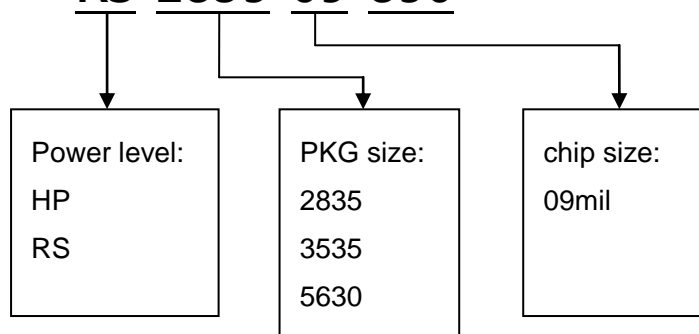

Features

- 850nm Vertical-Cavity Surface-Emitting Laser
- Low Dependence of Electrical and Optical Characteristics over Temperature

Applications

- Automotive sensing
- Gesture Recognition
- Time of Flight
- IR illumination

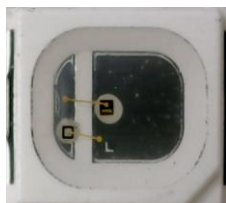

Sample dimension / Unit: mm

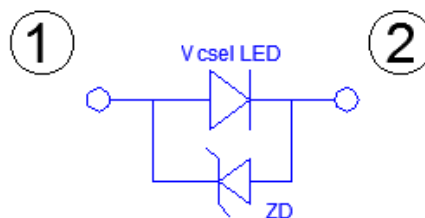
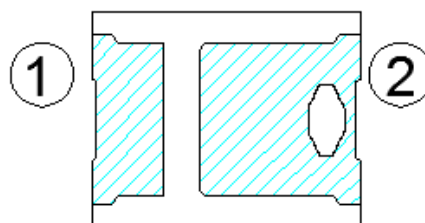
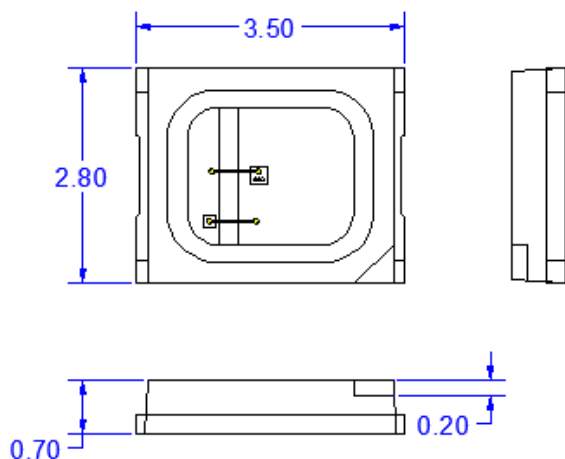

Electro-Optical Characteristics @ Ta = 25°C

Parameter	Symbol	Condition	Min.	Typ.	Max.	Unit
Forward Voltage	V _F	I _F = 25 mA	-	2.0	-	V
Threshold Current	I _{th}	-	-	5	-	mA
Slop Efficiency	η	I _F = 25 mA		0.6		mW /mA
Wavelength	λ _p	I _F = 25 mA	-	850	-	nm
Spectral width at half height	Δλ	I _F = 25mA	-	4	-	nm
Output Power	P _o	I _F = 25 mA	10	-	-	mW

Typical Electro-Optical Characteristics Curce

Forward Current vs. Forward Voltage

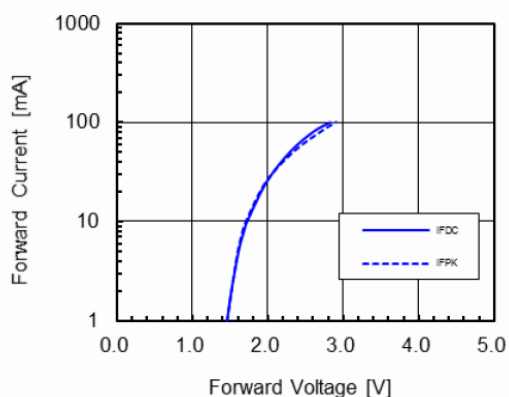

Relative Radiant Power vs Wavelength

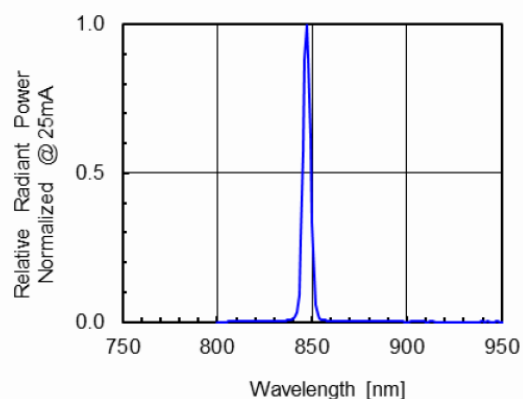

Relative Radiant Power
vs. Forward DC Current

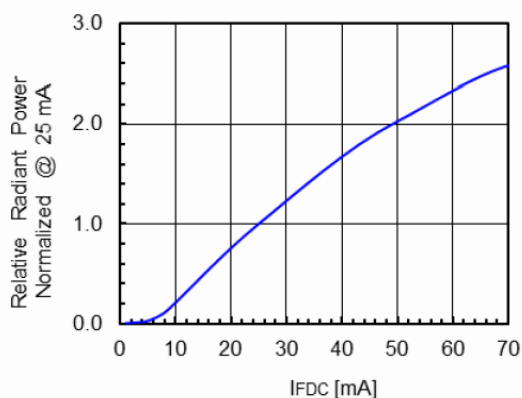

Forward DC Voltage vs. Temperature

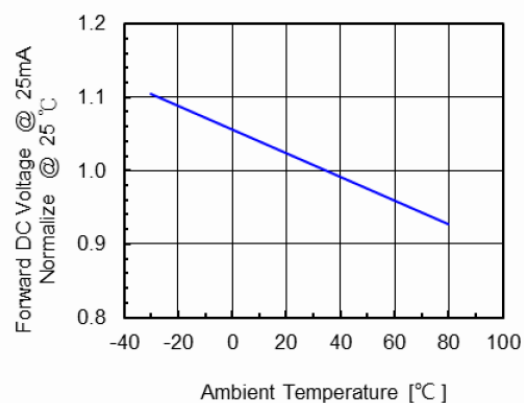

Reflow Soldering Profile

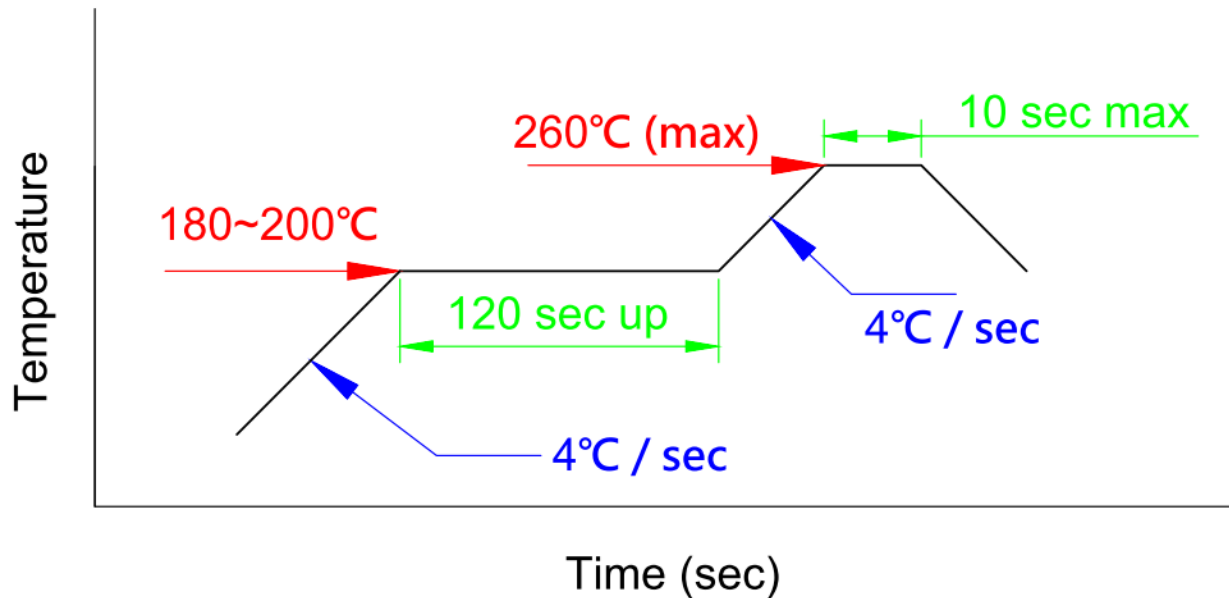

- Reflow soldering should not be done more than twice .
- When soldering , do not put stress on the Modules during heating .

Soldering iron

- When hand soldering, the temperature of the iron must be $\leq +300^{\circ}\text{C}$ for 3 seconds .
- Hand soldering should be performed only once .

Reflow Soldering



Dimensions of Tape



Dimensions of Reel

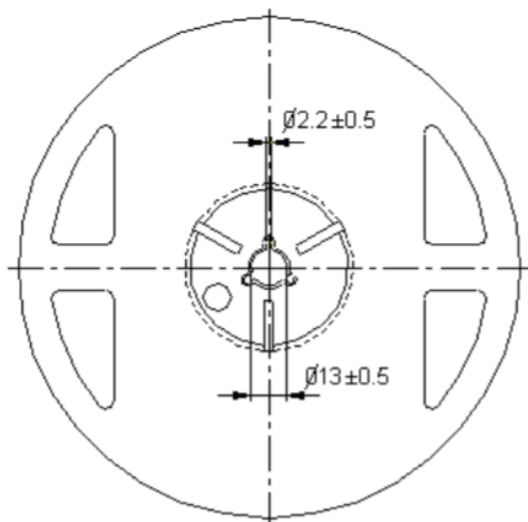

Note: 01. The tolerance unless mentioned is $\pm 0.1\text{mm}$
02. The measured unit is "mm"

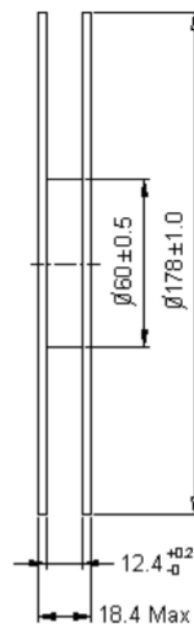

- 1 Reel / bag.
- Q' ty: 1000 PCS / Reel