

## MIV-32 PROTECTIVE VENTS



- Protective Vents reliably block ingress of wide range of contaminants, from rain and insects to dirt, dust, sand and other particulates, and enable water vapor molecules to diffuse through the microporous membrane, and pass freely out of the enclosure.
- IP68 protection class (2 meters / 60 min.) and -40°C to +125°C operating temp. range. Best to use under the tough environment.
- Installing on the side face of enclosures is effective for outdoor use.

## Dimensions

## Installation drawing

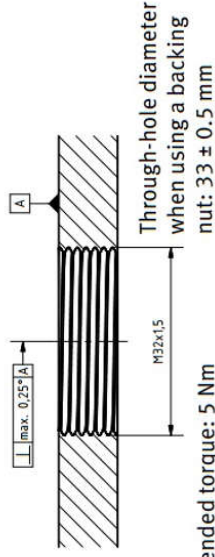
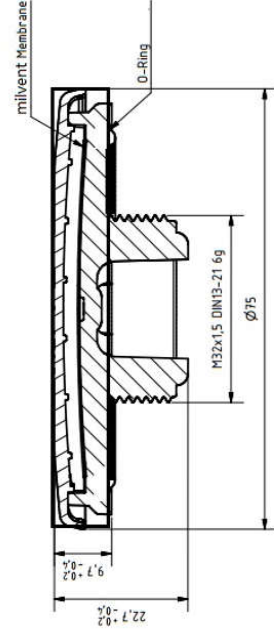

Recommended torque: 5 Nm

Through-hole diameter when using a backing nut: 33 ± 0.5 mm

- Applicable wall thickness is up to 4.0mm when using the lock nut.

## Color Type

Color code	Color
S	Light gray RAL7035
B	Black RAL9011

## Technical data

Part no.	MIV-32 □	MIV-32 HA □
Typical airflow	11L/min(dp=12mbar)	16L/min(dp=12mbar)
Water entry pressure	>0.3bar/30sec	>0.2bar/30sec
Recommended torque	0.6 ~ 0.8 Nm	
Environmental performance	IEC529, 2nd (Protection class) : IP66 · IP67 · IP68 (Immersion : 2 meters / 1h) · IP69K IEC60068-2-1, 2, 14 (Heat resistance) : -40°C~+125°C IEC600-2-78 (Humidity testing) : 85°C · 85% humidity - 1,000 hours UL94V-0 f1 (Flame resistant)	

## Part no. / Components

- Please suffix color code at the end of part number □ when ordering PMF series

Part no.	Material			Sales unit
	① Housing	② Membrane	③ O-ring	④ Lock nut
MIV-32 □	PC (UL94V-0)	PTFE	Silicone	PA6(UL94V-2)
MIV-32 HA □	PC (UL94V-0)	PTFE	Silicone	PA6(UL94V-2)