

MIV SERIES

Ventilation Parts

MIV-CAM VENTILATION CABLE GLAND



- >Maintain high airflow in large outdoor lighting or enclosure
- >Equalize pressure and reduce condensation by allowing air to flow freely into and out of sealed large enclosures.
- >Prevent lighting condensation.
- >IP68 protection class(2meters/60min.) and -40° C to +125° C operating temp.range.Best to use under the tough environment.
- >Reliably Protect sensitive electronics against water and other liquids.
- >Installing on the side face of enclosures is effective for outdoor use.

If wall of thickness is <3mm, recommend use nuts.

- There is two types of material:
Part No. Code Remark:
B(Brass); S(SUS) , For examples:
MIV-M8C-05B(a brass material M8)
MIV-M8C-05S(a SUS material M8)
All the Rubber Material Using Silicone

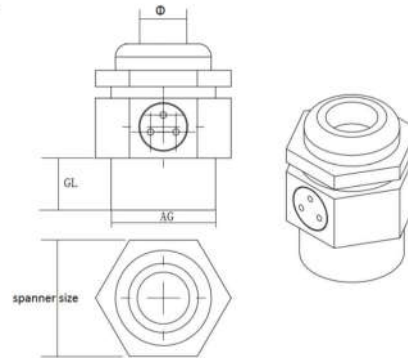

Technical Data

Thread	Item No.	Cable Range (mm)	Thread OD(mm)	Panel Mounting Hole(mm)	Thread Length(mm)	Joint Length(mm)	Spanner Size	Airflow
M8x1.0	MIV-M8C-05	5.0-3.0	8	8-8.2	5	16	12	20L/H@7kpa
M8x1.25	MIV-M8C-05	5.0-3.0	8	8-8.2	5	16	12	20L/H@7kpa
M12x1.0	MIV-M12C-06	7.0-3.5	12	12-12.2	7	16	16/14	20L/H@7kpa
M12x1.25	MIV-M12C-06	7.0-3.5	12	12-12.2	7	16	16/14	20L/H@7kpa
M12x1.5	MIV-M12C-06	7.0-3.5	12	12-12.2	7	16	16/14	20L/H@7kpa
M12x1.5	MIV-M12C-08	8.0-4.5	12	12-12.2	7	16	16/14	20L/H@7kpa
M12x1.5	MIV-12C-08-15	8.0-4.5	12	12-12.2	15	16	16/14	20L/H@7kpa
M12x1.5	MIV-M12C-09	8.9-6.5	12	12-12.2	7	16	16/14	20L/H@7kpa
M14x1.5	MIV-M12C-08	8.0-4.5	14	14-14.2	7	16	16/16	20L/H@7kpa
M14x1.5	MIV-M12C-09	8.9-6.5	14	14-14.2	7	16	16/16	20L/H@7kpa
M16x1.5	MIV-M16C-08	8.0-4.5	16	16-16.2	8	20	18/18	25L/H@7kpa
M16x1.5	MIV-M16C-10	5.0-10	16	16-16.2	8	20	18/18	25L/H@7kpa
M18x1.5	MIV-M18C-09	8.9-6.5	18	18-18.2	8	20	20	25L/H@7kpa
M18x1.5	MIV-M18C-10	10-7.5	18	18-18.2	8	20	20	25L/H@7kpa
M20x1.5	MIV-M20C-10	10-7.5	20	20-20.2	9	20	22	25L/H@7kpa
M20x1.5	MIV-M20C-12	12.0-10.0	20	20-20.2	9	20	22	25L/H@7kpa

PG SERIES

PG7	MIV-PG7-06	7.0-3.5	12.5	12.5-12.7	7	16	16/14	20L/H@7kpa
PG9	MIV-PG9-10	5-1.0	15.2	15.2-15.4	8	20	18/18	25L/H@7kpa
PG13.5	MIV-PG13.5-10	7.0-12	20.4	20.4-20.6	9	20	22	25L/H@7kpa