

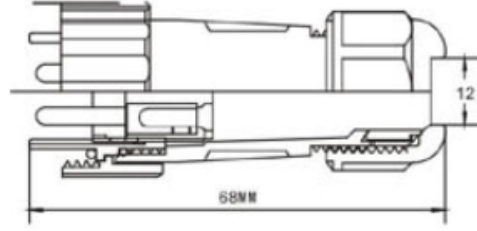

MT Connectors Series

Connectors

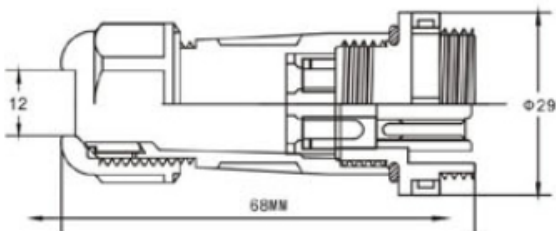

MT20 Screw Type 2pin



MT20 Thread Type 3pin



MT20 Thread Type 4Pin



MT20 Thread Type 5Pin



ϕ 5-11MM



MT20 Round Board
2Pin



MT20 Round Board
3Pin



MT20 Round Board
4Pin



MT20 Round Board
5Pin

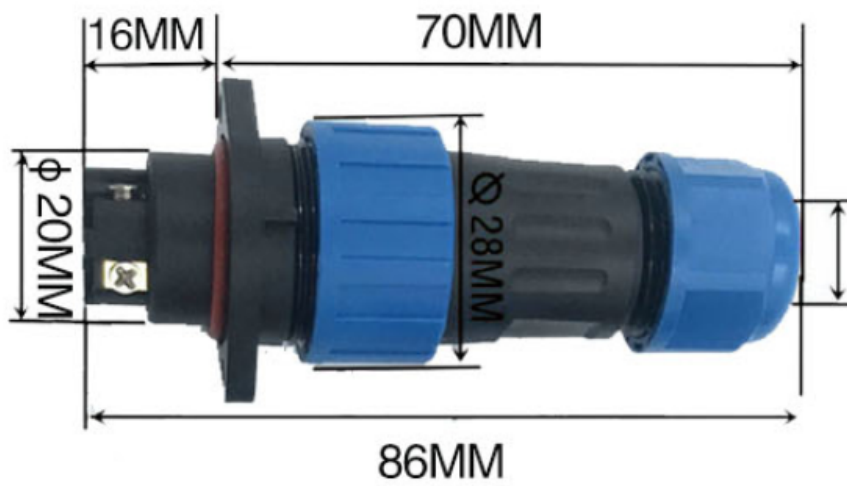

$\phi 5-11\text{MM}$



MT20 Socket-2holes

2Pin



MT20 Socket-2holes

3Pin



MT20 Socket-2holes 4Pin



Male Female

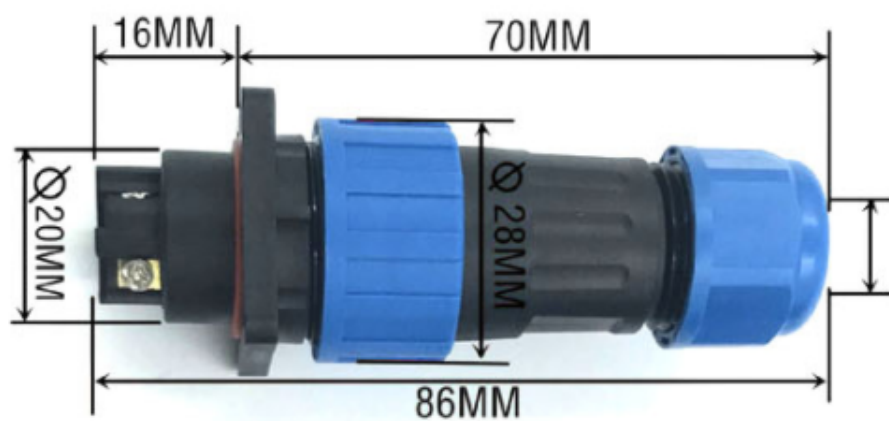

MT20 Rec-4holes 2Pin



MT20 Rec-4holes 3Pin



MT20 Rec-4holes 4Pin



MT28 2PIN



Male Female



MT28 3PIN



Male Female



MT28 4PIN



Male Female



MT28 Round Board 2Pin

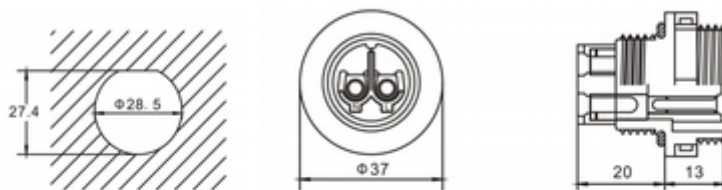

Assembly Hole



Male

Female

MT28 Round Board 3Pin

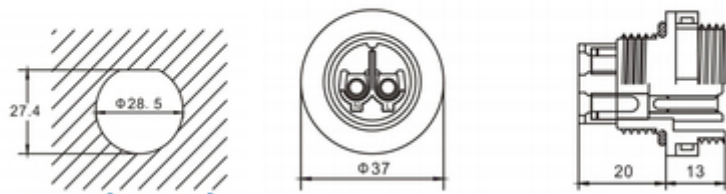

Assembly Hole



Male

Female

MT28 Round Board 4 Pin

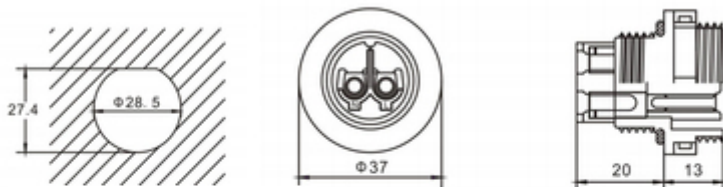

Assembly Hole



Male

Female

MT28 REC Board2PIN

Assembly Hole

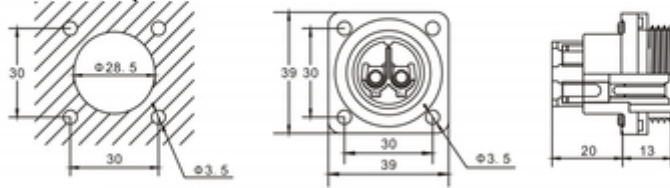

Male

Female

MT28 REC Board3PIN

Assembly Hole

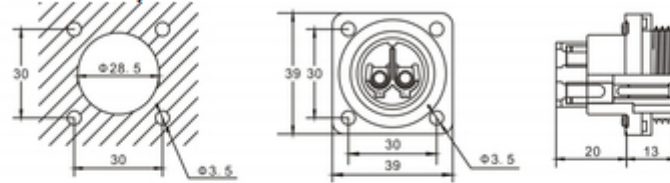

Male

Female

Product type	Connector	Overmolded Cable Assemblies
Coupling	Threaded coupling	Threaded coupling
Shell material	Nylon66 , fire resistance : V-0	PC、 PVC, fire resistance:V-0; Locking nut material: Anodized aluminum
Insert material	PPS max temperature 260 ,C , fire resistance : V-0	PPS max temperature 260 ,C , fire resistance : V-0
Contact material	Brass with gold plating	Brass with gold plating
Termination	SP13: solder, SP17: solder/crimp, SP21: solder/ screw/crimp	

Cable outer diameter range	Refer to Above Drawing	
IP rating	IP68	IP66
Mating cycle	>500	>500
Temperature range	-25C~ + 85"C	-20C~+85C
Insulation resistance Mfi	2000	2000

Feel Free to Contact with us:
milvent@milvent.com